



**OLDFIELD
SCHOOL**

My Guide to Oldfield School Class of 2021/22



Name: _____

Primary School: _____

New school: Oldfield School

Welcome!

This booklet is to be completed over summer and brought in on the first day of school. We are really looking forward to meeting you in September!

The address of my new school is _____
The telephone number is _____
The name of the Head Teacher is _____
The Head of Year 7 is _____
School starts at _____
School finishes at _____
I will travel by _____
To get to school on time, I will need to leave my house by _____
I will attend the school from _____ September 2021

Life at Secondary School:

- List 3 things you are looking forward to:

1. _____
2. _____
3. _____

- List 3 things you may need help with:

1. _____
2. _____
3. _____

Key Teachers



Mr Mackay
Head Teacher



Mrs Mills
Assistant Head Teacher &
Year 7 Link



Ms Lobbett
Deputy Headteacher &
Year 7 Link



Miss Davies
Head of Year 7



Ms Crosbie
SENCO



Mrs Henry
Pastoral Support Worker

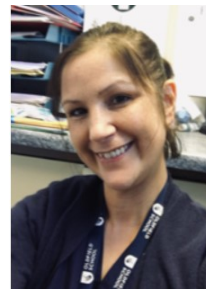

Ms Bahadur
School Nurse

Map of the School

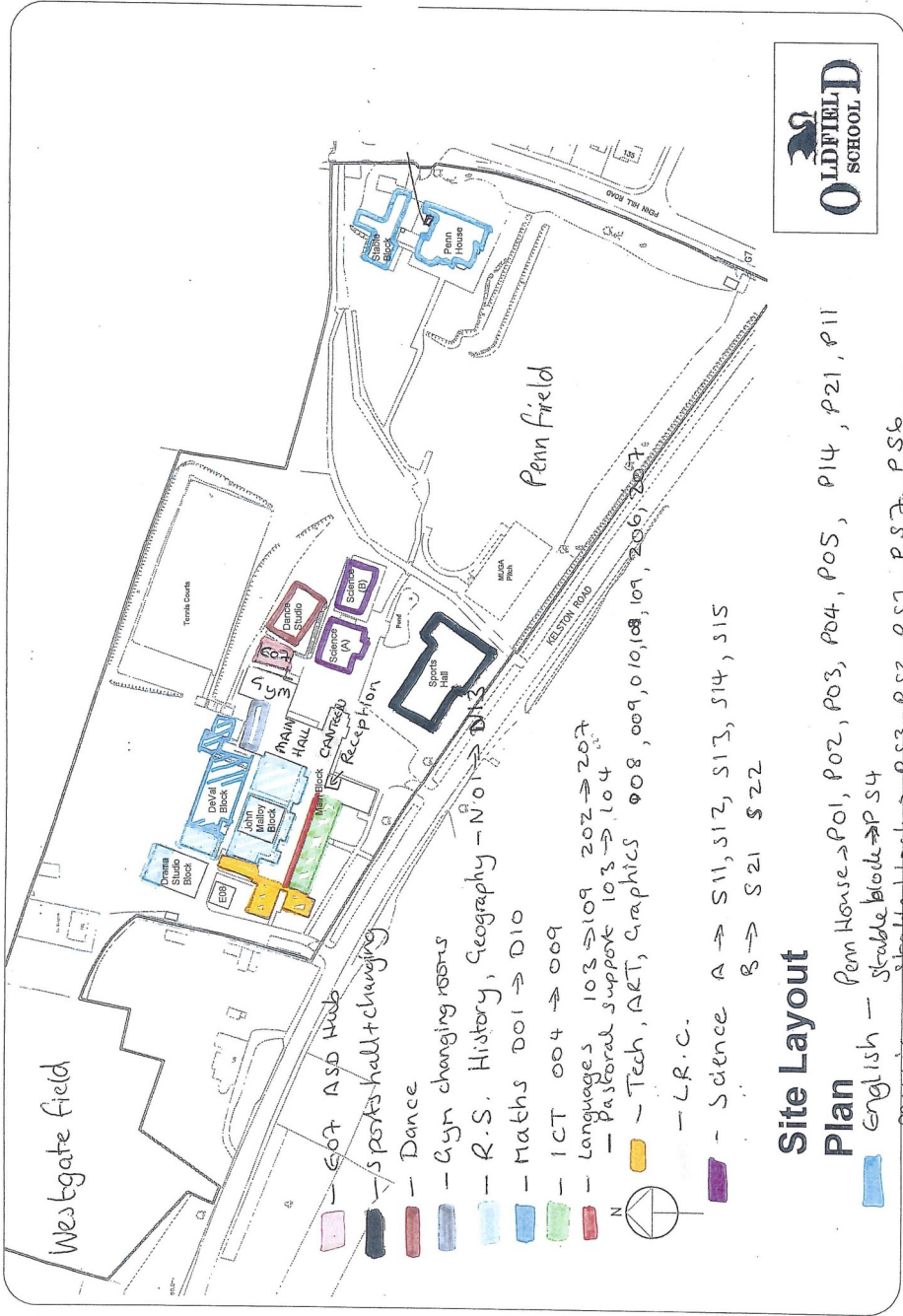

- 507 ASD Hub
- sports hall changing
- Dance
- Gym changing rooms
- R.S. History, Geography - N01 → D13
- Maths D01 → D10
- ICT 004 → 009
- Languages 103 → 109 202 → 207
- Pastoral support 103 → 104
- Tech, A&T, Graphics 008, 009, 010, 108, 109, 206, 207
- L.R.C.
- Science A → S11, S12, S13, S14, S15
- B → S21 S22

Site Layout

Plan

- English - Stable block → P.S4
- music - stable block → P.S3, P.S2, P.S1, P.S7, P.S6

Penn House → P01, P02, P03, P04, P05, P14, P21, P11

Sample Timetable

	1	2	3	4	5
Mon1	Eng PAN P05	PE JOD Gym2	Geog CRH N11	Music HAM PS4	Science HLA S15
Tue1	PE JOD Gym2	History DAB D03	Tech EVC Food Techn	Maths RBV D04	Spanish MAK 202
Wed1	ICT HED ICT Room 7	Spanish MAK 202	Eng PAN P05	Maths RBV D04	Religious ST BIP DS3
Thu1	Dance BER GYM1	Science GAC S15	ICT HED ICT Room 7	Eng PAN P05	Maths RBV D04
Fri1	Drama WHS Dance Studi	Maths RBV D04	Art PEJ Art Room 8	Science GAC S15	Eng PAN P05
Mon2	Maths RBV D04	Art DAR Art Room (1	Science GAC S11	Eng PAN P05	Spanish MAK 202
Tue2	Drama WHS Drama Studi	PE JOD Gym2	Tech EVC Food Techn	Spanish MAK 202	Science SCE S15
Wed2	Eng PAN P05	Science GAC S22	Religious ST BIP DS3	Maths RBV D04	History DAB D03
Thu2	Maths RBV D04	Geog CRH N11	Eng PAN P05	Science WJ S13	Spanish MAK 202
Fri2	Tech EVC Food Techn	Music HAM PS4	Geog CRH N11	PE JOD Gym2	History DAB D03

BER: Mrs R C Bell
 BIP: Ms P Bird
 CRH: Mr H Crow
 DAB: Ms B Davies
 DAR: Miss R G Davies
 EVC: Miss C Evans
 GAC: Mr C Gann
 HAM: Mr M D Hayward
 HED: Mr D Herbert

HLA: Mrs L Hobbs
 JOD: Mr D John
 MAK: Miss K MacKellar-Still
 PAN: Miss N J Payton
 PEJ: Mr J Pearce
 RBV: Miss V Robinson
 SCE: Ms S Cover
 WHS: Ms S D Whitehead
 WJ: Mrs J Williams



Don't worry if you get lost
 - just ask a teacher, our
 lovely prefects or another
 student who will know the
 way!



The Hemmings Centre





Penn House

Who am I?

My height	
My shoe size	
My favourite dinner	
My pet hate	
My favourite subject	
Eye colour	
Hair colour	
Achievements I am proud of	

My family and I

Interview one of your family members to see what they would say about you!

What are my best qualities?

What are my strengths and talents?

How do I deal with a challenge?

What advice would you give me to make the most of my start at Oldfield?



When you come to Oldfield School you will have PSHE lessons (Personal, Social, Health and Economic education) which will focus on you and the wider world, healthy relationships and your wellbeing. We cover lots of topics and have discussions in class; we encourage you to join in and have opinions. In the wordle below, we have ways in which we can all learn differently in lessons. Can you pick out two words that represent you?



We want you to create your own 'My Magnificent Mind' poster. Fill up your 'mind' with drawings, pictures and words about you! You can use words you picked from the wordle above too. Include things like your favourite colour or food or the names of friends and pets.

You can also include what you are looking forward to doing at Oldfield in Year 7; new clubs, school productions, new subjects and meeting new friends!

What have you been doing and thinking about in your last term?

You can write down feelings and thoughts in your 'mind' too!

Bring your 'My Magnificent Mind' poster to school with you in September. We would love to make a display of your work to create a huge Year 7 Mind. You don't have to include your own name in your mind but make sure it is in your own style!

You could cut out words from newspapers, magazines, paint your mind, use fabric or other materials. It really is up to you. Show us who you want to be at Oldfield School!

My Magnificent Mind



Homework

Homework – the more organised you are; the less amount of time you will have to spend doing it. In Year 7 you start to get more homework than you have been used to. Teachers will be stricter about getting it done and handed in on time. However, teachers are also there to help you if you are stuck so you should always ask them about anything before the task deadline.



To help you be successful in organising your homework, you will be able to access it on 'Satchel:one' (originally called *Show My Homework*). It tells you the dates it needs to be in and teachers can upload information about the task so you don't need to worry about forgetting what was said in class!

Equipment

At Oldfield school, you will be expected to have your own pencils, pens, ruler, rubber and calculator. You will have to carry them with you. These are the most important items to bring to school.

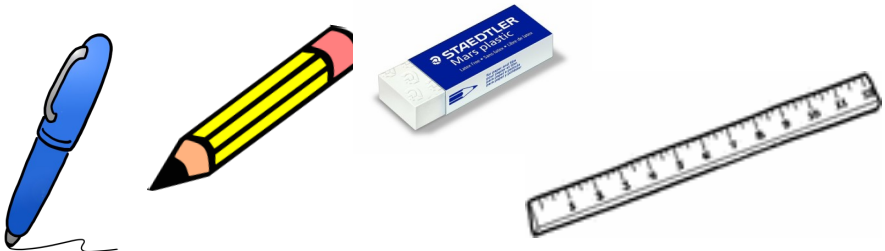

Organisation Tips

You'll have to remember lots of things when you start such as books, equipment and homework.

- ◆ Plan ahead! Use your timetable to check what books and equipment you need to pack. Pin up your timetable somewhere where you can easily see it.
- ◆ Work out your own routine for what you need to do the evening before (e.g. homework, packing bag) so you can be relaxed and punctual in the morning.
- ◆ Pack your bag the night before.
- ◆ Keep all your books and equipment in one place, like a box in your room.



Why not make a list of all the equipment you'll need (pencils, pens, ruler, calculator, etc.) and practise packing your bag now?

School uniform & PE kit



Below, write any questions you would like to ask on your first day:

Which house will you join in September 2020?



See you soon!



**OLDFIELD
SCHOOL**